

Section : Pre-Delivery
 Ref. No. : PD-0008
 Date : April 2000
 Page : 1 of 1

Area Application : Europe, Australia

Model Name : RAV4

Model Code : ACA20, ACA21, ZCA25, ZCA26

Subject : CUT FUSE INSTALLATION DURING PDS

This is to inform you that the CUT fuse has been removed on the RAV4 at assembly plant to reduce parasitic current draw in transit and storage.

The removed CUT fuse (30 A) is stored on the back of the Junction Block cover in the engine compartment.

The CUT fuse must be reinstalled during PDS (Pre-Delivery Service) in dealership as shown below.

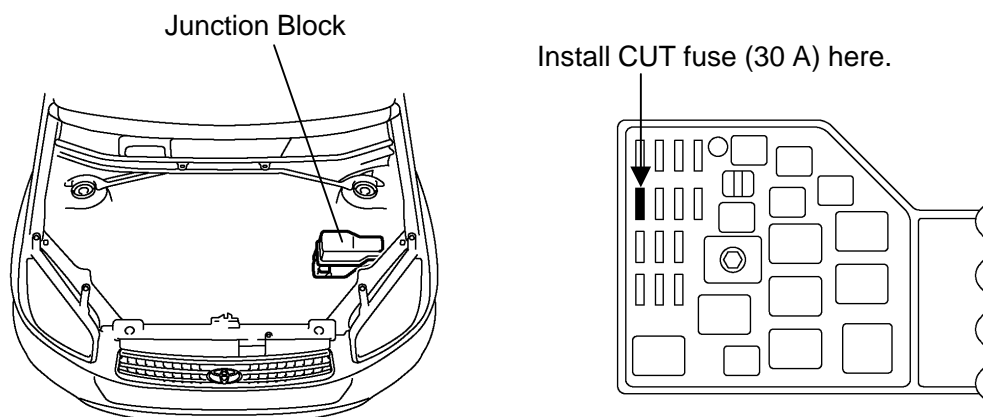

NOTE:

- Removing the CUT fuse cuts off power sources relating to the DOME fuse and RADIO fuse.
- If the vehicle is stored in dealership for a long time after installation of the CUT fuse in PDS, please disconnect the negative battery terminal to prevent parasitic current draw from flattening the battery.

Production Effective:

VIN	Production Date
-----	May 2000